

BX · MC · FLEX

26

Screw-In Connectors & Couplings



27

90° Angle Connectors & Set Screw Flex Connectors



28-29

Squeeze Connectors, EMT to Flex Couplings & Combination Connector



30

Duplex Connector & BX Connector



31

Saddle Connector & Strap Connector



32

One Hole Straps, Anti Short Bushings & Snap-in Flex



Screw-In Greenfield Connectors

Tornillo-En Los Conectores De Greenfield

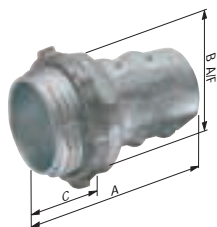

Use:
Screw-in type connectors are used to terminate Flexible Metal Conduit to a knock-out in a dry location box or enclosure, where minimum spacing is desired between the conduits.

Uso:
Los conectores roscados se utilizan para realizar las conexiones de los conductos metálicos flexibles con las bocas de cajas o recintos en lugares secos, donde se necesita que haya poco espacio entre los conductos.

Materials / Materiales :

• Zinc Die-Cast / El Cinc Fundió A troquel

Certification / Certificación :

UL E155411 NSF LR57925

Standards / Estándares :

UL 514B
CSA C22.2 No. 18
NEMA FB-1
NEC Article 350

Screw-In Greenfield Couplings

Tornillo-En Los Conectores De Greenfield

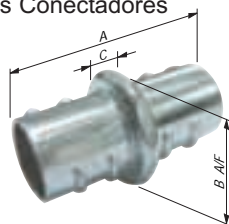

Use:
Screw-in type couplings are used to join lengths of Flexible Metal Conduit.

Uso:
Los acopladores roscados se utilizan para unir tramos de conductos metálicos flexibles.

Materials / Materiales :

• Zinc Die-Cast / El Cinc Fundió A troquel

Certification / Certificación :

UL E155411 NSF LR57925

Standards / Estándares :

UL 514B CSA C22.2 No. 18
NEMA FB-1 NEC Article 350B

BX • MC • FLEX

Catalog Number	UPC No 0-31857	Trade Size	Nominal Dimensions			Pcs/ Unit	Ctn/Case Qty/Qty	Case Wt.
			A	B	C			

Carded

18129	18129-1	3/8"	1.30	0.92	0.41	4	10/120	28.4
18130	18130-7	1/2"	1.37	0.92	0.41	4	10/120	29.9
18131	18131-4	3/4"	1.63	1.12	0.43	2	5/60	13.9

Polybag

44009	44009-1	3/8"	1.30	0.92	0.41	5	20	5.4
49009	49009-6	3/8"	1.30	0.92	0.41	1	50	2.9
44010	44010-7	1/2"	1.37	0.92	0.41	5	20	5.8
45010	45010-6	1/2"	1.37	0.92	0.41	10	20	11.3
49010	49010-2	1/2"	1.37	0.92	0.41	1	50	3.1
44011	44011-4	3/4"	1.63	1.12	0.43	5	20	8.7
49011	49011-9	3/4"	1.63	1.12	0.43	1	20	2.0

Boxed

56009	56009-6	3/8"	1.30	0.92	0.41	-	50/500	27.5
GC-38	66009-3	3/8"	1.30	0.92	0.41	-	50/100	13.2
56010	56010-2	1/2"	1.37	0.92	0.41	-	50/500	28.5
GC-50	66010-9	1/2"	1.37	0.92	0.41	-	50/100	13.9
56011	56011-9	3/4"	1.63	1.12	0.43	-	25/250	22.3
GC-75	66011-6	3/4"	1.63	1.12	0.43	-	25/125	11.2
02-56012	56012-6	1"	1.92	1.35	0.56	-	10	1.9
02-57013	57013-2	1 1/4"	2.12	1.75	0.61	-	10	2.7
02-57014	57014-9	1 1/2"	2.32	2.1	0.62	-	10	3.9
02-57015	57015-6	2"	2.55	2.66	0.75	-	10	5.9

Boxed w/ Insulated Throat

56109		3/8"	1.30	0.92	0.41	-	50/500	25.3
56110		1/2"	1.37	0.92	0.41	-	50/500	30.1
56111		3/4"	1.63	1.12	0.43	-	25/250	23.9
56112		1"	1.92	1.35	0.56	-	25/250	41.6
56113		1 1/4"	2.12	1.75	0.61	-	10/100	24.9
56114		1 1/2"	2.32	2.1	0.62	-	10/40	16.7
56115		2"	2.55	2.66	0.75	-	10/40	23.8

Trade Size

3/8" For Regular Wall Steel or Aluminum Flexible Metal Conduit.
1/2" For Regular Wall Steel or Aluminum Flexible Metal Conduit.
3/4" For Regular or Reduced Wall Steel or Aluminum Flexible Metal Conduit.
1"-2" For Regular Wall Steel or Aluminum Flexible Metal Conduit.

For Cable Sizes

For Regular Wall Steel or Aluminum Flexible Metal Conduit.
For Regular Wall Steel or Aluminum Flexible Metal Conduit.
For Regular or Reduced Wall Steel or Aluminum Flexible Metal Conduit.
For Regular Wall Steel or Aluminum Flexible Metal Conduit.

BX • MC • FLEX

Catalog Number	UPC No 0-31857	Trade Size	Nominal Dimensions			Pcs/ Unit	Ctn/Case Qty/Qty	Case Wt.
			A	B	C			

Carded

18127	18127-7	1/2"	1.79	0.97	0.20	1	10/120	10.7
18128	18128-4	3/4"	2.00	1.21	0.22	1	10/120	14.8

Polybag

44013	44013-8	1/2"	1.79	0.97	0.20	5	20	5.2
49013	49013-3	1/2"	1.79	0.97	0.20	1	20	2.8
44014	44014-5	3/4"	2.00	1.21	0.22	5	20	8.6
49014	49014-0	3/4"	2.00	1.21	0.22	1	25	2.4

Boxed

56013	56013-3	1/2"	1.79	0.97	0.20	-	10/500	24.6
56014	56014-0	3/4"	2.00	1.21	0.22	-	25/250	21.7
02-56015	56015-7	1"	2.41	1.47	0.32	-	10	1.6
02-56016	56016-4	1 1/4"	2.75	1.88	0.32	-	10	2.5
02-56017	56017-1	1 1/2"	3.00	2.28	0.32	-	10	3.7
02-56018	56018-8	2"	3.28	2.84	0.32	-	10	5.2

90° Angle Connectors

Conectores Del Ángulo Del 90°

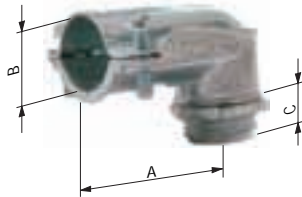

Use:
90° connectors are used to make a 90° termination of Armored Cable, Metal Clad Cable or Flexible Metal Conduit to a knock-out or unthreaded slip hole in a dry location box or enclosure.

Uso:
Los conectores con ángulo de 90° se utilizan para realizar conexiones de 90° de cables blindados, cables con revestimiento metálico o conductos de metal flexible con las bocas de las cajas eléctricas o con los agujeros de deslizamiento sin rosca en cajas o en recintos en lugares secos.

Materials / Materiales :

• Zinc / El Cinc Fundió A troque

Certification / Certificación :

UL E155411 SP LR57925

Standards / Estándares :

UL 514B
CSA C22.2 No. 18
NEMA FB-1
NEC Articles 350, 333 & 334

BX • MC • FLEX

Catalog Number	UPC No 0-31857	Trade Size	Nominal Dimensions			Pcs/ Unit	Ctn/Case Qty/Qty	Case Wt.
			A	B	C			
Carded								
18110	18110-9	3/8"	1.32	1.30	0.39	2	10/120	25.1
18111	18111-6	1/2"	1.64	1.63	0.43	1	5/60	11.5
18113	18113-0	3/4"	1.77	1.89	0.43	1	5/60	14.6
Polybag								
44801	44801-1	3/8"	1.32	1.30	0.39	2	20	3.9
49801	49801-6	3/8"	1.32	1.30	0.39	1	50	4.8
44804	44804-2	1/2"	1.64	1.63	0.43	2	20	5.5
49804	49804-7	1/2"	1.64	1.63	0.43	1	20	2.8
44806	44806-6	3/4"	1.77	1.89	0.43	2	20	7.7
49806	49806-1	3/4"	1.77	1.89	0.43	1	20	4.0
Boxed								
55801	55801-7	3/8"	1.32	1.30	0.39	-	50/500	44.8
55804	55804-8	1/2"	1.64	1.63	0.43	-	25/250	31.1
55806	55806-2	3/4"	1.77	1.89	0.43	-	10/100	18.5
02-55807	55807-9	1"	2.13	2.30	0.53	-	10	3.2
02-55808	55808-6	1 1/4"	3.00	2.69	0.59	-	10	4.8
02-55809	55809-3	1 1/2"	4.80	3.59	0.70	-	4	4.4
02-55810	55810-9	2"	4.80	3.59	0.70	-	4	4.6
02-55811	55811-6	2 1/2"	4.80	4.45	0.85	-	5	12.9
02-55812	55812-3	3"	5.58	5.00	0.85	-	1	3.5
02-55813	55813-0	3 1/2"	6.41	5.51	1.02	-	1	6.3
02-55814	55814-7	4"	7.22	6.10	1.06	-	1	7.4

Trade

Size
3/8"

For Cable Sizes

For regular Wall Steel or Aluminum Flexible Metal Conduit. For 14-2 through 10-3 Steel or Aluminum Armored Cable. For 14-2 through 10-3 Interlocking Steel or Aluminum Metal clad Cable.

1/2"

For Regular Wall Steel or Aluminum Flexible Metal Conduit. For 8-2 through 8-3 Steel or Aluminum Armored Cable. For 8-2 through 8-3 interlocking Steel or Aluminum Metal clad Cable.

3/4"

For regular or Reduced Wall Steel or Aluminum Flexible Metal Conduit.

Set screw Flex Connectors

Conectores de la flexión del tornillo de presión

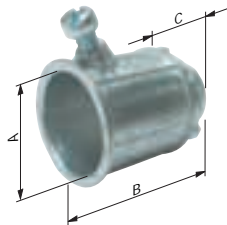

Use:
Set screw flex connectors are used to terminate Regular Wall Steel or Aluminum Flexible Metal Conduit to a knock-out in a dry location box or enclosure.

Uso:
Los conectores flexibles con tornillos de sujeción se utilizan para conectar los conductos metálicos flexibles de acero o de aluminio para paredes comunes con una boca o un recinto en lugares secos.

Materials / Materiales :

• Zinc Die-Cast / El Cinc Fundió A troquel

Certification / Certificación :

UL E155411 SP LR57925

Standards / Estándares :

UL 514B CSA C22.2 No. 18
NEMA FB-1 NEC Article 350

BX • MC • FLEX

Catalog Number	UPC No 0-31857	Trade Size	Nominal Dimensions			Pcs/ Unit	Ctn/Case Qty/Qty	Case Wt.
			A	B	C			
Carded								
18125	18125-3	1/2"	0.95	1.50	0.40	1	10/120	15.7
18126	18126-0	3/4"	1.15	1.55	0.49	1	5/60	11.1
Polybag								
44090	44090-9	1/2"	0.95	1.50	0.40	3	20	5.7
49090	49090-4	1/2"	0.95	1.50	0.40	1	25	2.6
44091	44091-6	3/4"	1.15	1.55	0.49	3	20	7.3
49091	19091-1	3/4"	1.15	1.55	0.49	1	25	3.4
Boxed								
56090	56090-4	1/2"	0.95	1.50	0.40	-	25/250	23.19
56091	56091-1	3/4"	1.15	1.55	0.49	-	25/250	35.25

Squeeze Connectors

Conectores Del Apretón

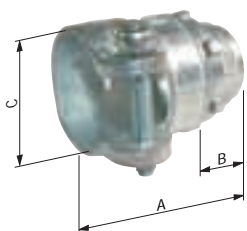

Use:

Squeeze connectors are used to terminate Flexible Metal Conduit to a knock-out in a dry location box or enclosure.

Uso:

Los conectores a presión se utilizan para realizar las conexiones de los conductos metálicos flexibles con las bocas de 1/2 pulgada en una caja o un recinto en lugares secos.

Materials / Materiales :

- Zinc Die-Cast / El Cinc Fundió A troquel

Certification / Certificación :

UL E155411 S LR57925

Standards / Estándares :

UL 514B
CSA C22.2 No. 18
NEMA FB-1
NEC Article 350

BX • MC • FLEX

Catalog Number	UPC No 0-31857	Trade Size	Nominal Dimensions			Pcs/ Unit	Ctn/Case Qty/Qty	Case Wt.
			A	B	C			
Carded								
18406	18406-3	3/8"	1.09	0.5	0.62	3	5/60	14.3
18407	18407-0	1/2"	1.50	0.5	0.99	2	5/60	13.9
18408	18408-7	3/4"	1.59	0.5	1.18	2	5/60	18.8
Polybag								
44401	44401-3	3/8"	1.09	0.5	0.62	3	20	4.1
49401	49401-8	3/8"	1.09	0.5	0.62	1	30	3.5
44407	44407-5	1/2"	1.50	0.5	0.99	3	20	5.3
49407	49407-0	1/2"	1.50	0.5	0.99	1	25	2.4
44408	44408-2	3/4"	1.59	0.5	1.18	3	20	8.0
49408	49408-7	3/4"	1.59	0.5	1.18	1	25	3.5
Boxed								
55401	55401-9	3/8"	1.09	0.5	0.62	-	50/500	32.0
55407	55407-1	1/2"	1.50	0.5	0.99	-	25/250	21.6
SC-50	65407-8	1/2"	1.50	0.5	0.99	-	25/125	9.9
55408	55408-8	3/4"	1.59	0.5	1.18	-	25/250	33.7
02-55410	55410-1	1"	1.75	0.5	1.45	-	10	2.1
02-55412	55412-5	1 1/4"	1.90	0.6	1.73	-	10	2.8
02-55414	55414-9	1 1/2"	2.00	0.6	2.00	-	10	3.6
02-55416	55416-3	2"	2.10	0.6	2.55	-	10	4.6

Trade Size

For Cable Sizes

3/8"	For Regular or Reduced Wall Steel Flexible Metal Conduit. For 12-2 through 10-3 Steel or Aluminum armored cable. For 12-2 through 10-3 Interlocking Steel or Aluminum Metal Clad Cable.
1/2"	For Regular or Reduced Wall Steel Flexible Metal Conduit. For 6-3 Steel or Aluminum Armored Cable. For 6-3 Interlocking Steel or Aluminum Metal Clad Cable.
3/4"	For Regular or Reduced Wall Steel or Aluminum Flexible Metal Conduit.

EMT To Flex Couplings

EMT Para doblar Acopladores

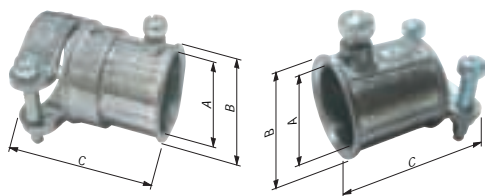

Use:

Combination couplings are used to provide a transition from steel EMT conduit to Flexible Metal Conduit.

- Set Screw Type

Uso:

Los acopladores de combinación se utilizan como transiciones entre conductos EMT de acero y conductos metálicos flexibles.

- Tipo Del Tornillo de presión

Materials / Materiales :

- Zinc Die-Cast / El Cinc Fundió A troquel

Certification / Certificación :

UL E210498 S LR57925

Standards / Estándares :

UL 514B CSA C22.2 No. 18
NEMA FB-1 NEC Articles 348 & 350

BX • MC • FLEX

Catalog Number	UPC No 0-31857	Trade Size	Nominal Dimensions			Pcs/ Unit	Ctn/Case Qty/Qty	Case Wt.
			A	B	C			
Carded								
18279	18279-3	3/8"	0.72	0.93	1.34	2	5/60	11.9
18280	18280-9	1/2"	0.93	0.87	1.62	1	5/60	9.1
18281	18281-6	3/4"	0.96	1.16	1.97	1	5/60	12.1
Polybag								
44279	44279-8	3/8"	0.72	0.93	1.34	2	20	3.0
49279	49279-3	3/8"	0.72	0.93	1.34	1	25	1.9
44280	44280-4	1/2"	0.93	0.87	1.62	2	20	3.8
49280	49280-9	1/2"	0.93	0.87	1.62	1	15	1.5
44281	44281-1	3/4"	0.96	1.16	1.97	2	20	6.0
49281	49281-6	3/4"	0.96	1.16	1.97	1	10	1.6
Boxed								
57003	57003-3	3/8"	0.72	0.93	1.34	-	50/500	34.3
55280	55280-0	1/2"	0.93	0.87	1.62	-	25/250	21.9
55281	55281-7	3/4"	0.96	1.16	1.97	-	25/250	36.0

EMT To Flex Couplings

EMT Para doblar Acopladores

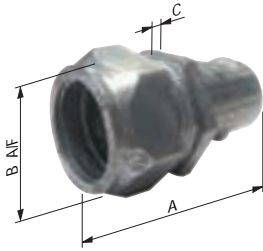

Use:
Combination couplings are used to provide a transition from steel EMT Conduit to Flexible Metal Conduit.

- Compression Type

Usa:
Los acopladores de combinación se utilizan como transiciones entre conductos EMT de acero y conductos metálicos flexibles.

- Tipo De la Compresión

Materials / Materiales :

- Zinc Die-Cast / El Cinc Fundió A troquel

Certification / Certificación :

UL E155411 SR LR57925

Standards / Estándares :

UL 514B CSA C22.2 No. 18
NEMA FB-1 NEC Articles 348 & 350

BX • MC • FLEX

Catalog Number	UPC No	Trade Size	Nominal Dimensions			Pcs/ Unit	Ctn/Case Qty/Qty	Case Wt.
			A	B	C			

Polybag

49289	49289-2	1/2"	1.40	0.92	0.15	1	20	1.8
49290	49290-8	3/4"	1.52	1.12	0.20	1	20	2.6
49291	49291-5	1"	1.77	1.35	0.31	1	20	3.7

Boxed

55289	55289-3	1/2"	1.40	0.92	0.15	-	50/500	40.9
55290	55290-9	3/4"	1.52	1.12	0.20	-	25/250	30.8
55291	55291-6	1"	1.77	1.35	0.31	-	25/250	46.1

Combination Connector

Conector De la Combinación

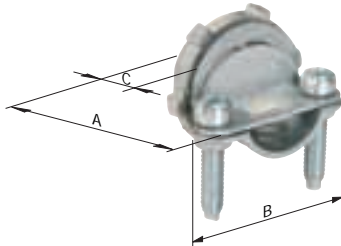

Use:
Clamp type connectors are used to terminate Armored Cable, Metal Clad Cable or Flexible Metal Conduit to a 1/2" knock-out in a dry box or enclosure.

- UL Listed Locknut
- Male Hub Threads NPS
- End Stopped

Usa:
Los conectores con abrazaderas se utilizan para conectar los cables blindados, cables con revestimiento de metal o conductos de metal flexible con las bocas de 1/2 pulgada en cajas o en recintos en lugares secos.

- Tuerca de fijación Mencionada de la UL
- El Cubo Masculino Rosca NPS
- Extremo Paró

Materials / Materiales :

- Zinc Die-Cast / El Cinc Fundió A troquel

Certification / Certificación :

UL E155411 SR LR57925

Standards / Estándares :

UL 514B CSA C22.2 No. 18
NEMA FB-1 NEC Articles 350, 333 & 334

BX • MC • FLEX

Catalog Number	UPC No	Trade Size	Nominal Dimensions			Pcs/ Unit	Ctn/Case Qty/Qty	Case Wt.
			A	B	C			

Carded

18058-1	80581-4	3/8"	0.80	1.17	0.35	3	10/120	20.9
---------	---------	------	------	------	------	---	--------	------

Polybag

44002	44002-2	3/8"	0.80	1.17	0.35	3	20	3.2
49502	49502-2	3/8"	0.80	1.17	0.35	1	100	5.2

Boxed

57002	57002-6	3/8"	0.80	1.17	0.35	-	100/1000	50.1
C-510	67002-3	3/8"	0.80	1.17	0.35	-	100/500	25.2

Trade Size
3/8"

For Cable Sizes

For Regular Wall Steel or Aluminum Flexible Metal Conduit.
For 14-2 through 10-2 Steel or Aluminum Armored Cable.
For 14-2(nominal OD .470") through 10-3 (nominal OD .610") Aluminum Interlocking Metal Clad Cable; 14-2 (nominal OD .469") through 10-3 (nominal OD .600") Steel Interlocking Metal Clad Cable.

Duplex Connector

Conector A dos caras

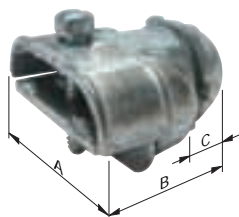

Use:

Duplex connectors are used to terminate two runs of Armored Cable, Metal Clad Cable or Flexible Metal Conduit to a 1/2" knock-out in a dry location box or enclosure.

- UL Listed Locknut
- Clamp Type
- Single Screw

Uso:

Los conectores dobles se utilizan para conectar de dos tramos de cables blindados, cables con revestimiento de metal o conductos metálicos flexibles con bocas de 1/2 pulgada en cajas o en recintos en ubicaciones secas.

- Tuerca de fijación Mencionada de la UL
- Tipo De la Abrazadera
- Solo Tornillo

Materials / Materiales :

- Zinc Die-Cast / El Cinc Fundió A troquel

Certification / Certificación :

UL E155411 SP LR57925

Standards / Estándares :

UL 514B CSA C22.2 No. 18
NEMA FB-1 NEC Articles 350, 333 & 334

BX Connector

Conector de BX

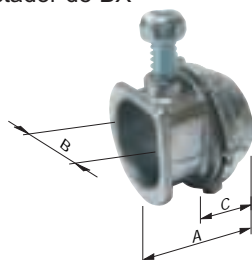

Use:

BX connectors are used to terminate steel Armored Cable to a 1/2" knock-out in a dry location box or enclosure.

- UL Listed Locknut
- End Stopped

Uso:

Los conectores para cajas se utilizan para conectar los cables blindados de acero con las bocas de 1/2 pulgada en cajas o en recintos en lugares secos.

- Tuerca de fijación Mencionada de la UL
- Extremo Parado

Materials / Materiales :

- Zinc Die-Cast / El Cinc Fundió A troquel

Certification / Certificación :

UL E155411 SP LR57925

Standards / Estándares :

UL 514B CSA C22.2 No. 18
NEMA FB-1 NEC Article 333

BX • MC • FLEX

Catalog Number	UPC No	Trade Size	Nominal Dimensions			Pcs/ Unit	Ctn/Case Qty/Qty	Case Wt.
			A	B	C			

Carded

18630	18630-2	3/8"	1.60	1.5	0.42	1	5/60	10.3
-------	---------	------	------	-----	------	---	------	------

Polybag

44630	44630-7	3/8"	1.60	1.5	0.42	2	20	4.6
49630	49630-2	3/8"	1.60	1.5	0.42	1	20	2.5

Boxed

55630	55630-3	3/8"	1.60	1.5	0.42	-	25/250	26.6
-------	---------	------	------	-----	------	---	--------	------

Trade Size

For Cable Sizes

3/8"

For Regular Wall Steel or Aluminum Flexible Metal Conduit.
For 14-2 (nominal OD .460") through 10-3 (nominal OD .500") Steel Armored Cable;
For 14-2 (nominal OD .480") through 10-3 (nominal OD .580") Aluminum Armored Cable.
For 14-2 (nominal OD .468") through 10-3 (nominal OD .610") Aluminum Interlocking Metal Clad Cable; 14-2 (nominal OD .470") through 10-3 (nominal OD .600") Steel Interlocking Metal Clad Cable.

BX • MC • FLEX

Catalog Number	UPC No	Trade Size	Nominal Dimensions			Pcs/ Unit	Ctn/Case Qty/Qty	Case Wt.
			A	B	C			

Carded

18058	18058-4	3/8"	0.78	0.63	0.36	4	10/120	28.3
-------	---------	------	------	------	------	---	--------	------

Polybag

44501	44501-0	3/8"	0.78	0.63	0.36	5	20	5.0
45501	45501-9	3/8"	0.78	0.63	0.36	10	20	9.6
46501	46501-8	3/8"	0.78	0.63	0.36	100	6	27.7
49501	49501-5	3/8"	0.78	0.63	0.36	1	100	5.2

Boxed

55501	55501-6	3/8"	0.78	0.63	0.36	-	100/1000	46.7
C-550	65501-3	3/8"	0.78	0.63	0.36	-	100/500	24.6

Trade Size

For Cable Sizes

3/8"

For 14-2 (nominal OD .460") through 10-2 (nominal OD .598") Steel Armored Cable.
For 14-2 (nominal OD .469") through 10-3 (nominal OD .600") Steel Interlocking Metal Clad Cable.

Saddle Connector

Conector De la Silla de montar

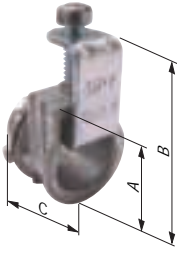

Use:

Saddle connectors are used to terminate Armored and Metal Clad Cables to a 1/2" knock-out in a dry location box or enclosure.

- UL Listed Locknut
- End Stopped

Uso:

Los conectores con abrazadera cóncava se utilizan para realizar conexiones de los cables blindados y los cables con revestimiento de metal con las bocas de 1/2 pulgada en una caja o un recinto en lugares secos.

- Tuerca de fijación Mencionada de la UL
- Extremo Parado

Materials / Materiales :

- Zinc Die-Cast / El Cinc Fundió A troquel

Certification / Certificación :



Standards / Estándares :

- UL 514B
- CSA C22.2 No. 18
- NEMA FB-1
- NEC Articles 333 & 334

BX • MC • FLEX

Catalog Number	UPC No	Trade Size	Nominal Dimensions			Pcs/ Unit	Ctn/Case Qty/Qty	Case Wt.
			A	B	C			

Polybag

44503	44503-4	3/8"	0.90	1.61	0.93	5	20	7.4
49503	49503-9	3/8"	0.90	1.61	0.93	1	50	3.9

Boxed

55503	55503-0	3/8"	0.90	1.61	0.93	-	50/500	35.4
-------	---------	------	------	------	------	---	--------	------

Trade Size

For Cable Sizes

3/8"

- For 14-2 (nominal OD .465") through 10-3 (nominal OD .500") Steel Armored Cable;
- For 14-2 (nominal OD .480") through 10-3 (nominal OD .585") Aluminum Armored Cable.
- For 0.475" through 0.600" Steel Interlocking Metal Clad Cable .
- For 0.468" through 0.610" Aluminum Interlocking Metal Clad Cable.
- For 12/2 through 10/3 Oval NMSE Cable.

Strap Connector

Conector De la Correa

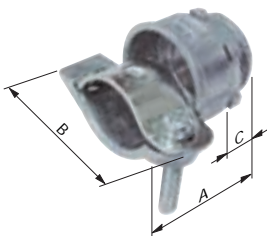

Use:

Strap Connectors are used to terminate Armored Cable and Metal Clad Cable to a steel outlet box or metal enclosure.

Uso:

Los conectores de la correa se utilizan para terminar el cable armado y el cable revestido del metal a un recinto de acero de la caja o del metal del enchufe.

Materials / Materiales :

- Zinc Die-Cast / El Cinc Fundió A troquel

Certification / Certificación :



Standards / Estándares :

- UL 514B
- CSA C22.2 No. 18
- NEC Articles 350, 333 & 334

BX • MC • FLEX

Catalog Number	UPC No	Trade Size	Nominal Dimensions			Pcs/ Unit	Ctn/Case Qty/Qty	Case Wt.
			A	B	C			

Boxed

55504	55504-7	1/2"	1.40	1.80	0.40	25	25/250	25.6
-------	---------	------	------	------	------	----	--------	------

Trade Size

For Cable Sizes

1/2"

- For 8-4 (nominal OD .785") through 8-2 (nominal OD .680") Steel Armored Cable;
- For 8-4 (nominal OD .780") through 8-2 (nominal OD .680") Aluminum Armored Cable.
- For 0.680" through 0.780" Steel Interlocking Metal Clad Cable ;
- For 0.675" through 0.780" Aluminum Interlocking Metal Clad Cable.

BX One Hole Strap

Correa Del Agujero de BX Uno

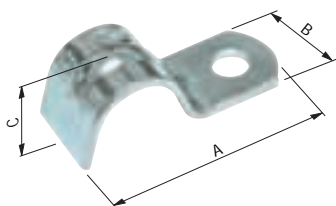

Use:
One hole straps are used to provide support for runs of Armored Cable.

Uso:
Las abrazaderas con un agujero se utilizan para brindar soporte a los tramos de cable blindado.

Materials / Materiales :

- Galvanized Steel / Acero Galvanizado
- Zinc Plated / Cinc Plateado

Snap-in Flex

Flexión Snap-in

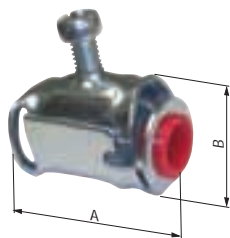

Use:
Snap-in connectors are used to terminate Armored cable.

- No tools needed

Uso:
Los conectadores snap-in se utilizan para terminar el cable armado.

- Ningunas herramientas necesitadas

Materials / Materiales :

- Steel / Acero

Anti-Short Bushings

Bujes Contra-Cortos

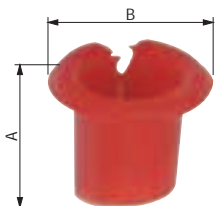

Use:
Anti-short bushings are inserted into the end of Armored Cable and Flexible Metal Conduit in order to protect the conductors from the sharp edges of the raceway where cut.

Uso:
Los casquillos antidescarga se insertan en los extremos de los cables blindados y de los conductos flexibles de metal para proteger los conductores contra los bordes filosos del canal de conducción eléctrica cuando éste se corta.

Materials / Materiales :

- Plastic / Plástico

BX • MC • FLEX

Catalog Number	UPC No	Trade Size	Nominal Dimensions			Pcs/ Unit	Ctn/Case Qty/Qty	Case Wt.
			A	B	C			
Polybag								
44919	44919-3	3/8"	1.27	0.5	0.47	10	20	3.0
47919	47919-0	3/8"	1.27	0.5	0.47	3	50	2.6
49919	49919-8	3/8"	1.27	0.5	0.47	4	50	3.1

Boxed								
55919	55919-9	3/8"	1.27	0.5	0.47	-	100/1000	13.9

BX • MC • FLEX

Catalog Number	UPC No	Trade Size	Nominal Dimensions			Pcs/ Unit	Ctn/Case Qty/Qty	Case Wt.
			A	B	C			
Polybag								
44440	44440-2	1/2"	1.45	0.97		3	10	14.0
Boxed								
AMC-50	63750-7	1/2"	1.45	0.97		-	50/250	115.0

BX • MC • FLEX

Catalog Number	UPC No	Trade Size	Nominal Dimensions			Pcs/ Unit	Ctn/Case Qty/Qty	Case Wt.
			A	B	C			
Carded								
18035	18035-5	0	0.57	0.66		35	10/120	8.0
Polybag								
02-55035	55035-6	0	0.57	0.66		35	20	0.8
02-55036	55036-3	1	0.62	0.66		35	20	1.0
02-55037	55037-0	2	0.60	0.84		35	20	1.3
02-55038	55038-7	3	0.68	0.94		20	10	0.8
02-55039	55039-4	4	0.80	1.15		16	10	0.5